

## Installation Instructions for AI13 HOME Gate Kit

It is the responsibility of the installer to meet all code and safety requirements, and to obtain all required building permits. The deck and railing installer should determine and implement appropriate installation techniques for each installation situation. The Fortress Company nor its distributors shall not be held liable for improper or unsafe installations.

### Read Instructions Completely Before Starting Installation

#### Note

When cutting Fortress railing, it is very important to complete the following at cut points. Not following the below steps will result in corrosion at the cut areas:

- Remove all metal shavings from the cut area
- File any sharp edges left by cutting. Thoroughly wipe and remove any filings, grime or dirt from the railing.
- Apply two coats of Fortress zinc-based touch-up paint to the cut area. If touch up is at rail ends, allow paint to dry before connecting bracket to post.
- Be sure to remove any metal shavings from the surface of deck, patio or balcony to prevent corrosion on the surface.

#### Required Materials

Circular Saw, Drill, T25 Bit Driver, #2 Philips Bit, 3/16" drill bit, Metal File, Paint or Paint Pen, Rubber Mallet, Tape Measure, Square, 10mm Wrench or small Crescent Wrench, and Marker or Pencil

#### Kit Includes:

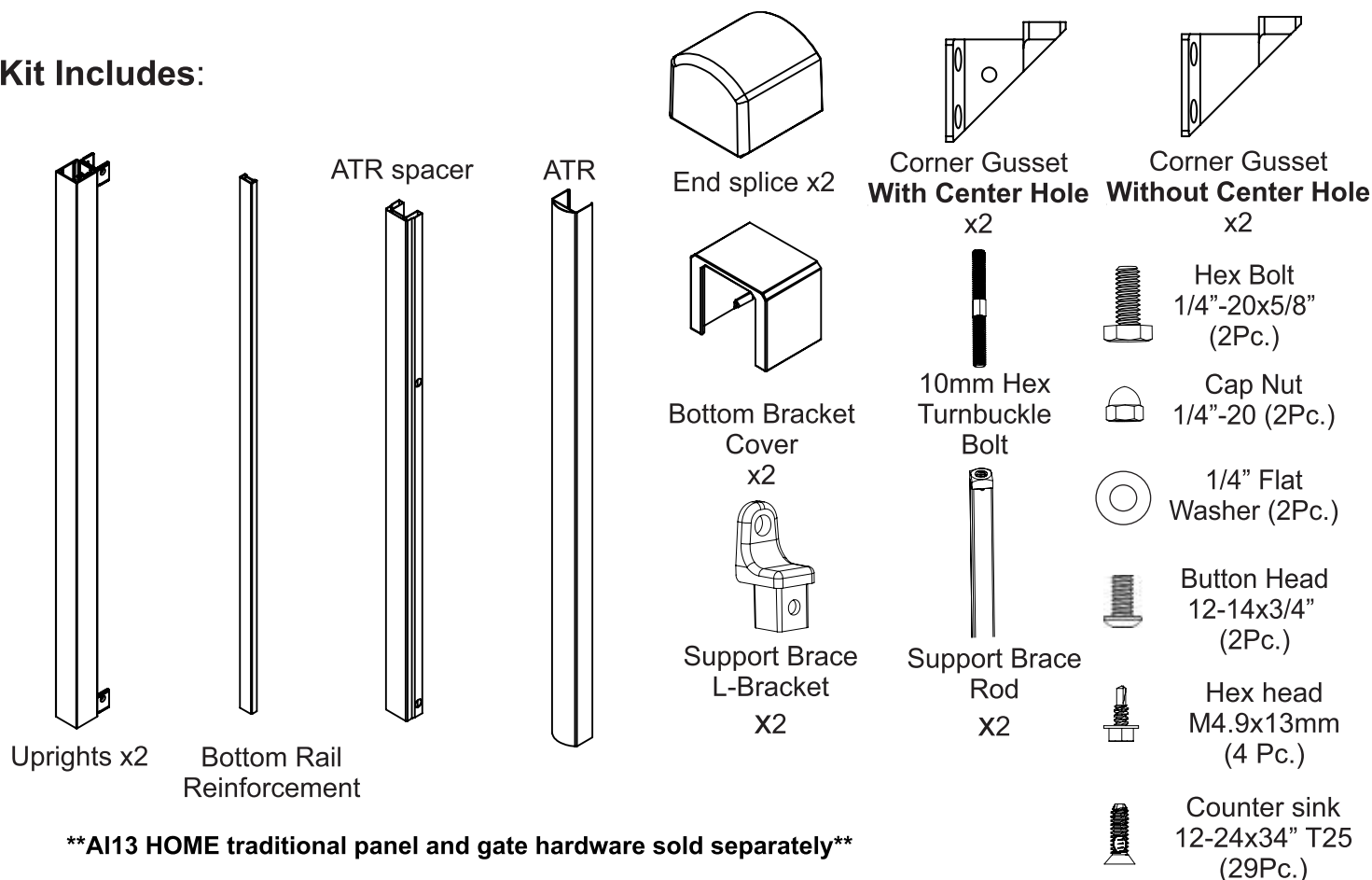

040720

For technical assistance, please email: [Customercare@fortressbp.com](mailto:Customercare@fortressbp.com)  
Hours of Operation: Monday through Friday 8:00 AM to 5:00 PM, CST  
Phone: 1-866-323-4766 Fax: 972-644-3720  
[www.Fortressbp.com](http://www.Fortressbp.com)

**Important - Every gate installation will be different. One fully assembled gate cannot measure over 48" [1219mm] in length. For ex. a gate opening measuring 96" [2438.4mm] between posts use two 48" [914mm] gate sections.**

### AI13 HOME Gate kit

Available Heights 32.5" [826mm], 40" [1016mm], and 44.5" [1130mm]. Maximum length of gate is 48" [1219mm].

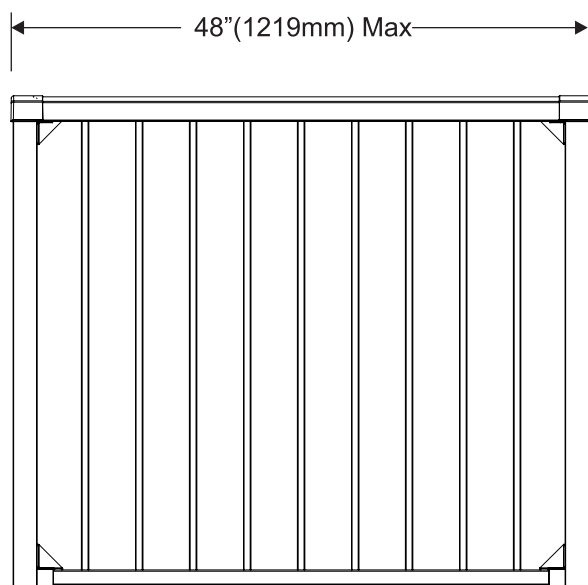

### STEP 1:

- Use a tape measure to measure the distance between posts for gate opening.

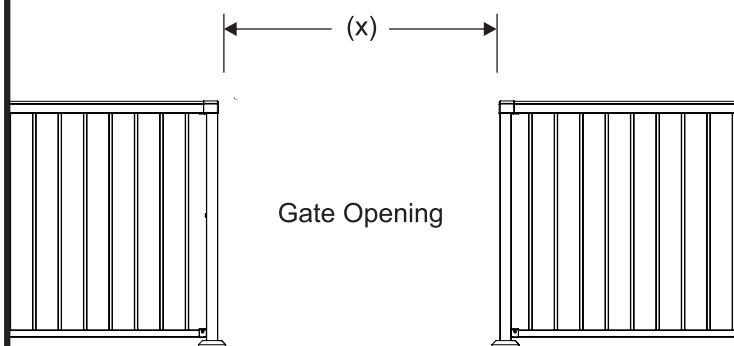

### STEP 2:

- Using dimension (x) in step 1, subtract 4.5" [114mm] from the total length. This is to accommodate for uprights and hinges in the overall width of the gate assembly.
- Next, cut down panel to desired width. **\*\*Note: Different hinges could change the required panel length. Be sure to allow for opening and closing distances\*\***
- Keep the panel symmetrical. Use a marker and speed square to keep cuts straight.

**\*\*Note: Minimum distance between the last picket and the end of the rail is 2 1/16" [52mm]\*\***

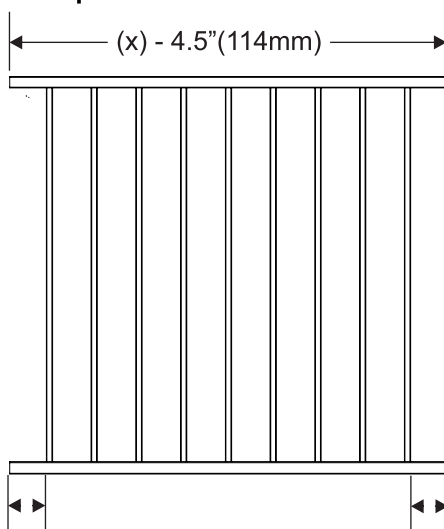

**\*\*Try to keep these dimension symmetrical\*\***

### STEP 3:

- (If necessary): Cut down ATR, ATR spacer and bottom rail support to match panel length.
- Test fit panel & uprights, and measure the max width of gate including uprights.
- Compare this measurement to the dimension in step 2.

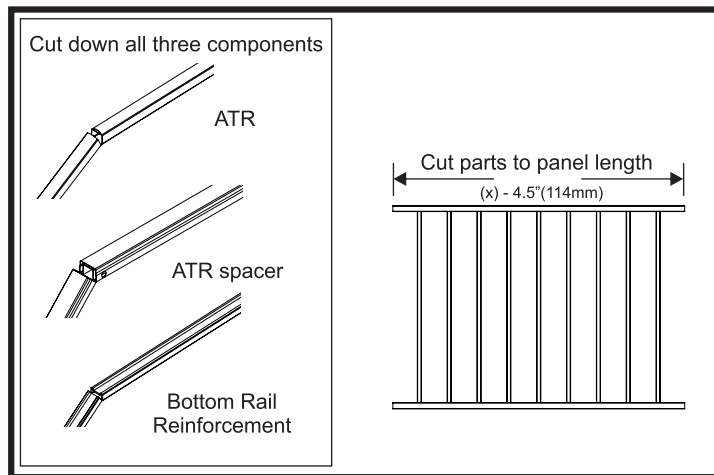

- Test fit using no hardware. Tape together if needed.

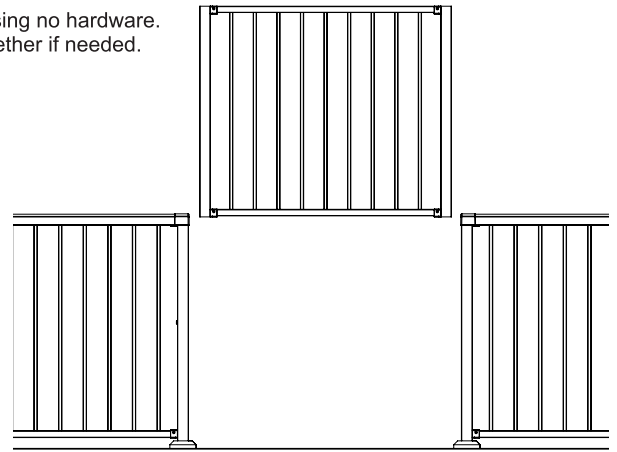

### STEP 4:

- File down metal shavings and paint all cut edges.

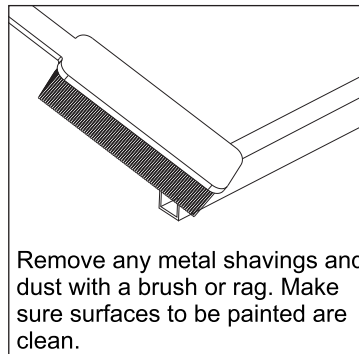
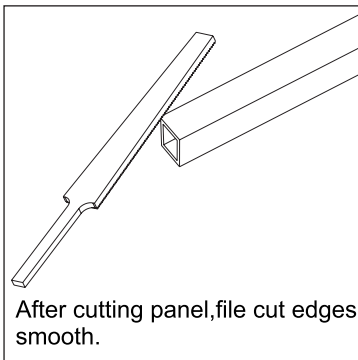

#### 1st Coat

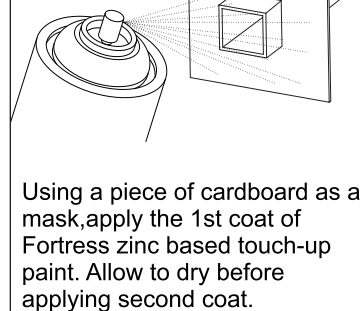

#### 2nd Coat

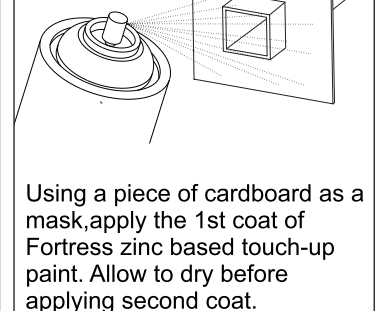

### STEP 5:

- Use a rubber mallet to install Bottom rail support.

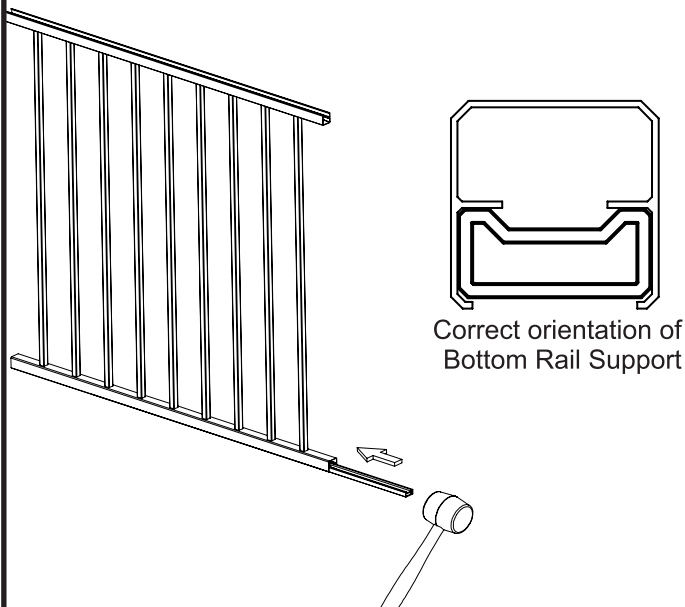

### STEP 6:

- Attach the panel to the uprights with two #12-24 X 3/4" T25 Thread Cutting screws in each bracket.
  - Pre-drill with 3/16" drill bit using one screw per bracket.
- \*\*\*use bracket as guide for screw hole\*\*\*

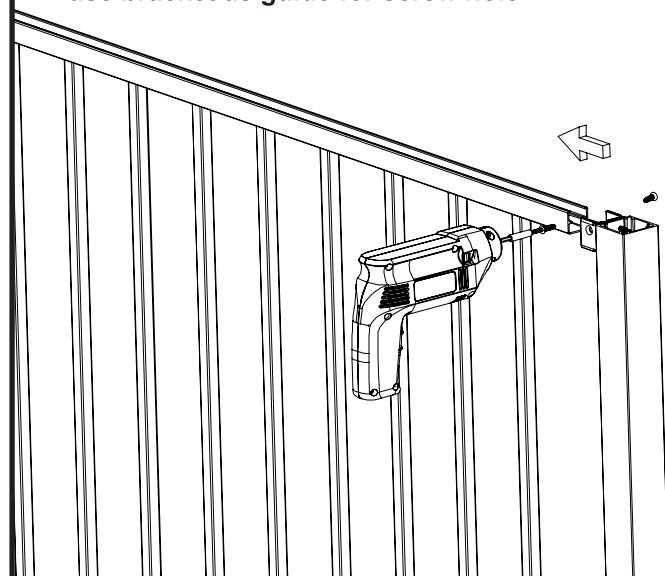

### STEP 7:

- Using a rubber mallet, tap the bracket caps onto the bottom brackets.

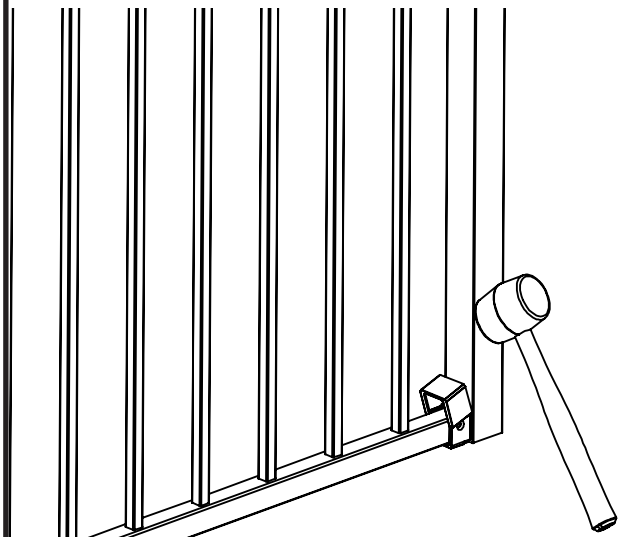

### STEP 8:

- Choose which side you will placing your gate hinge.
- Use painters' tape to mark placement of hinges.  
\*\*Gate hinge sold separately\*\*
- Place the gusset **with center hole** in the top corner closet to the upright with gate hinge.
- Center large face on the upright and small face flush on rail.
- Mark all five holes with marker or spring punch.

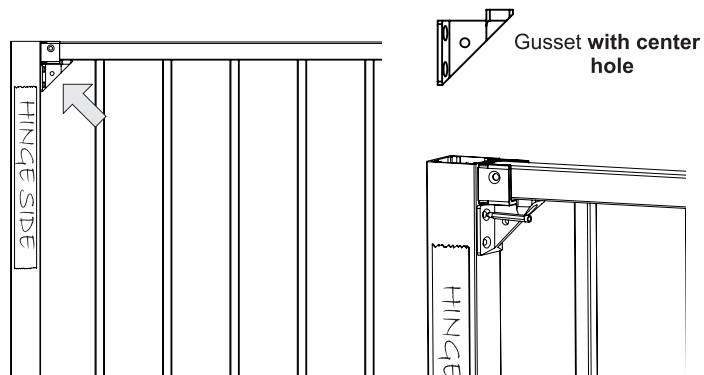

### STEP 9:

- Pre-drill all five screw holes using a 3/16 drill bit.
- Attach gussets using five 12-24 x3/4" T25 screws.

\*\*\*Note: if the picket is close to the upright, use an extension on your drill bit to avoid damaging the rail.\*\*\*

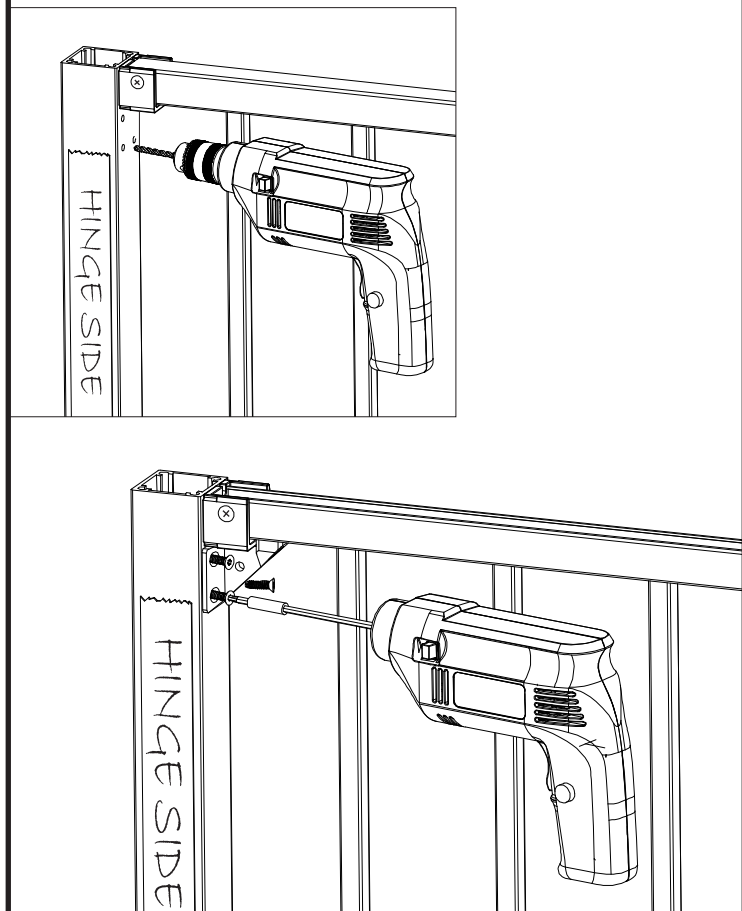

### STEP 10:

- Diagonal from the gusset installed in step 8.
- Repeat step 8-9 in the bottom corner using the two gusset **with center hole**.

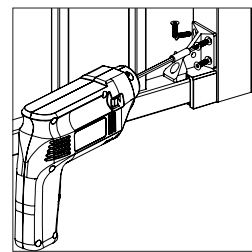
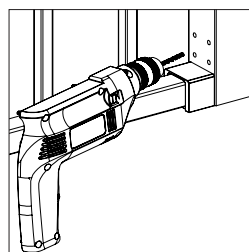
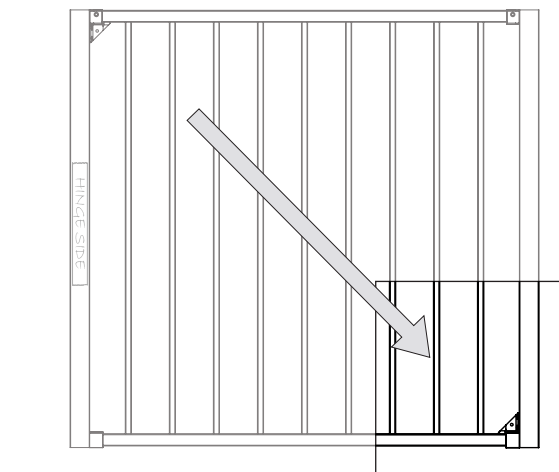

\*\*\* Reference step 8-9\*\*\*

### STEP 11:

- Using the two gussets **without center hole**, repeat steps 8-9 for the remaining top and bottom corners.

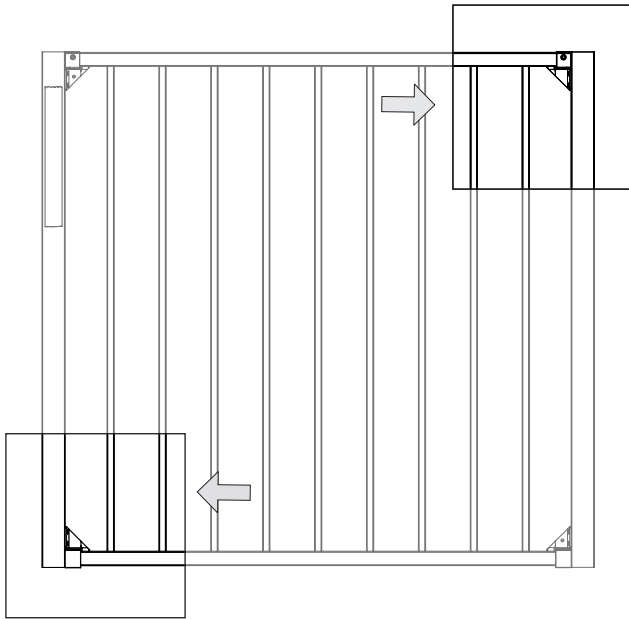

### STEP 12:

- Fasten Turnbuckle bolt on to one of the support rods threaded ends.
- Rotate Turnbuckle all the way in.
- Fasten 2nd support rod onto the other threaded end of the Turnbuckle bolt.
- Rotate support rod until Turnbuckle bottoms out.

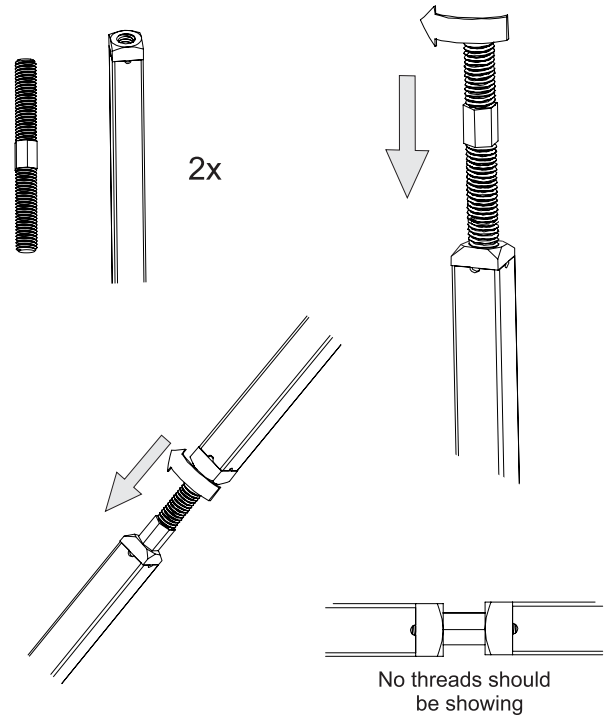

### STEP 13:

- Insert the two L-brackets into the open ends of the support brace.
- Use two 12-14x3/8 T25 button head screws.

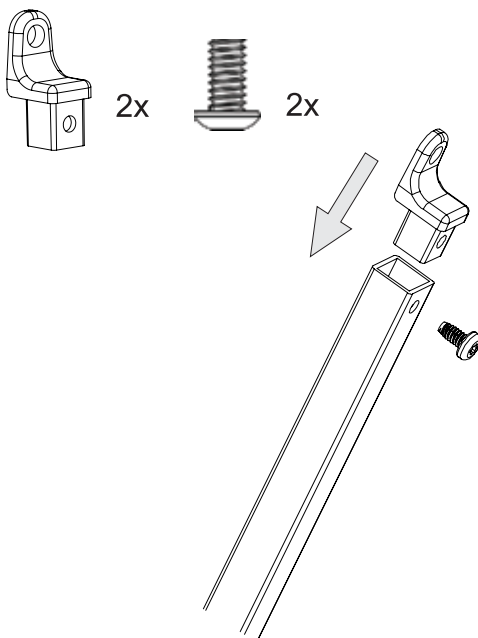

### STEP 14:

- Use the assembled support brace from step 12 and 13.
- Fasten support brace to top corner gusset **with center hole**.
- Fasten support brace with one 1/4"-20x5/8" Hex Bolt, one 1/4" Flat washer, and one 1/4"-20 Cap Nut.

\*\*\*Note: Leave bolt hand tight\*\*\*

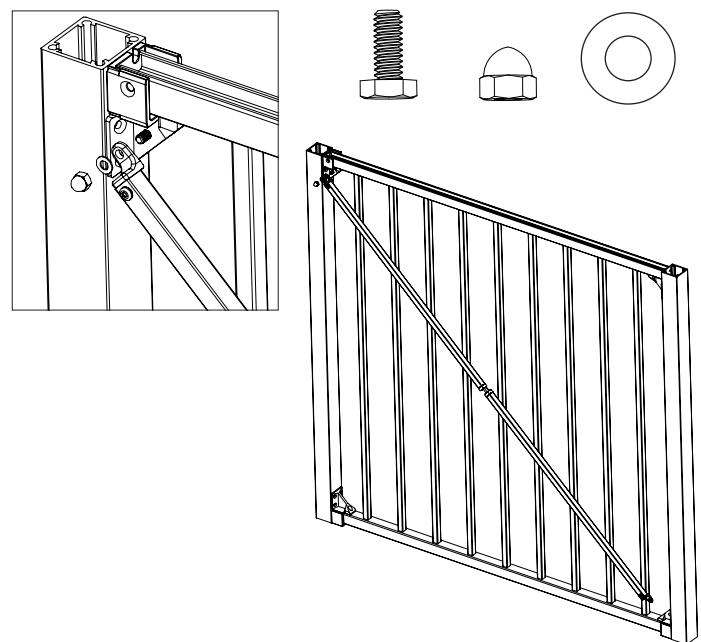

### STEP 15:

- Adjust Turnbuckle until the bottom support brace is in-line with the center hole in the corner gusset.
- Use the same hardware at step 14.

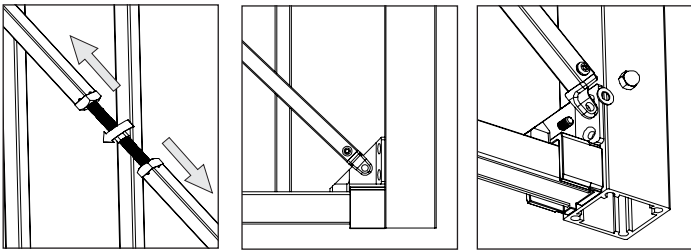
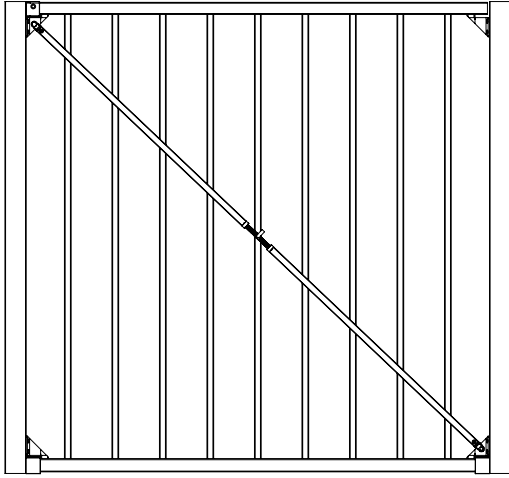

### STEP 16:

\*\*\* Required only if support brace is too long\*\*\*

- Remove support brace from gate.
- Remove both L-brackets from support rod.
- Cut support rod ends to desired length.

\*\*\* keep support rod symmetrical cut from both ends\*\*\*

\*\*\* Repeat step 4 for any modification made to gate kit component\*\*\*

- Pre-drill screw hole for L-Bracket with 3/16" drill bit.
- Reinstall bracket with screws.
- Reinstall support brace onto gate.

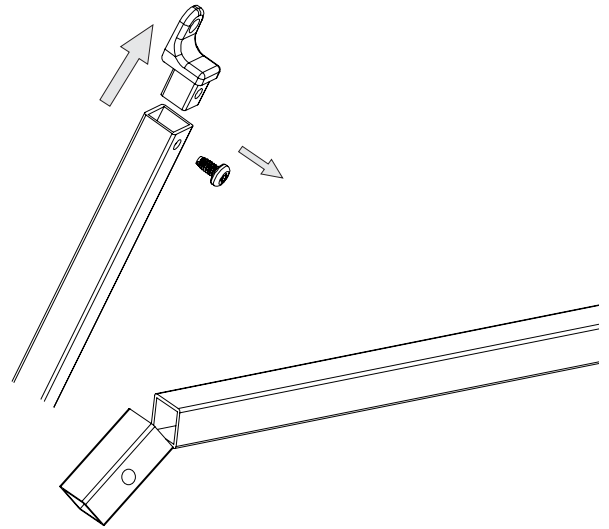

### STEP 17:

- Tighten down all support brace hardware.
- Use 10mm wrench to tension support brace Turnbuckle.

\*\*\* Do not over tighten\*\*\*

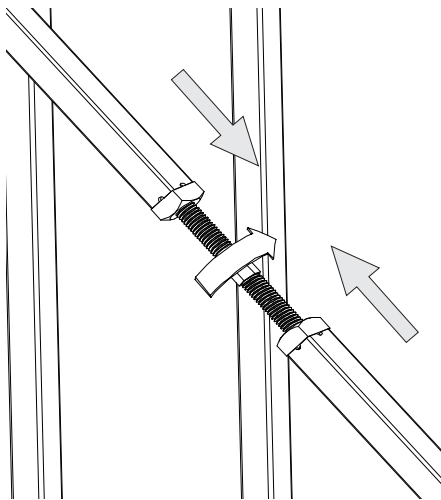

### STEP 18:

- Use the M4.9 X 13mm hex head screw to attach the ATR spacer to the top rail in all 4 holes. If one of the screw holes was cut off during the sizing of the panel, use a step bit to add another hole 1" from the end of the rail.

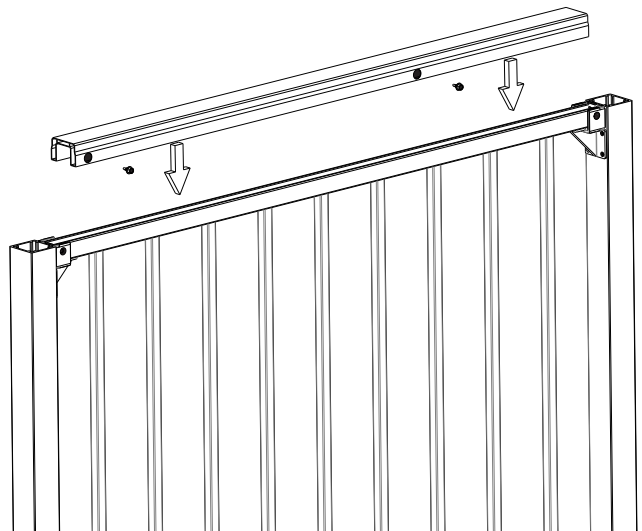

### STEP 19:

- Evenly place the double sided tape provided onto the top of the ATR spacer.

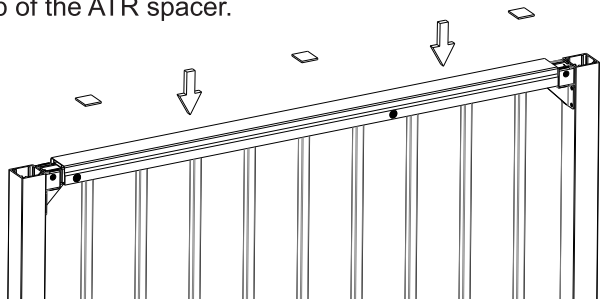

### STEP 20:

- Snap the ATR over the ATR Spacer. Center on the rail.

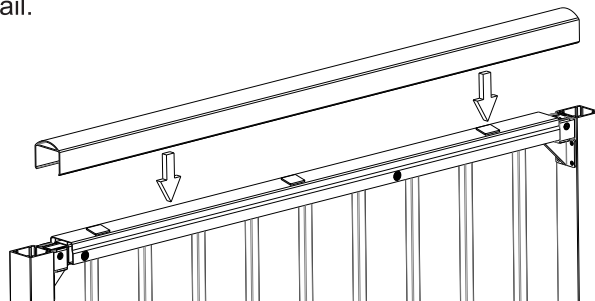

### STEP 21:

- Place the End splice onto the gate uprights and use a mallet with a rubber head (same color mallet as the rail works best) to press the caps into place.

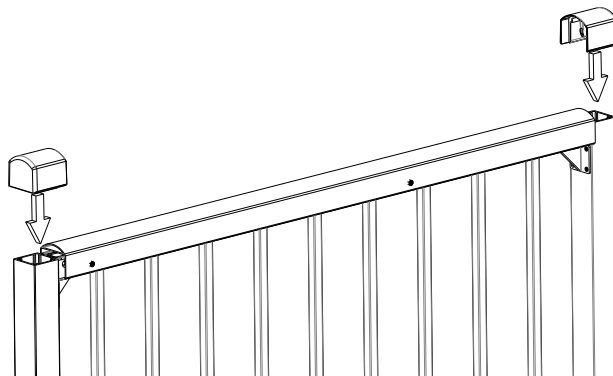

### STEP 22:

- Follow gate kit hardware instructions to attach hinges and attach the assembled gate to the posts.

**\*\* Gate kit hardware sold separately\*\***

